

Meet your tablet.

verizon[✓]

Para la versión en español, visite
verizonwireless.com/Support

SAMSUNG
Galaxy Tab S3

Setting up your tablet

Your tablet already has a SIM card installed.

Optional: Insert the microSD card

1. With the tablet face up, insert the card tray removal tool, that came with your tablet into the hole on the microSD™ card tray.



2. Insert the microSD card into the microSD card tray with the gold contacts facing down.



3. Gently close the microSD card tray.

NOTE: The microSD card is sold separately.

Charge your tablet

Before turning on your tablet, charge it fully.

Your tablet comes with a charger and a USB cable. Plug the smaller end of the cable into the USB/charger port on your tablet and the other end into the charger. Then plug the charger into an electrical outlet to charge the tablet.

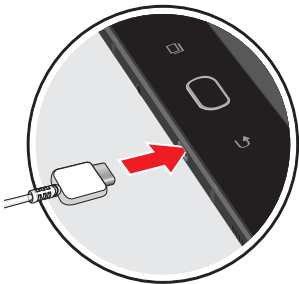

WARNING: Only use approved chargers with your device. Incompatible chargers or tampering with the charging port could damage your device and void the warranty.

About your tablet



Not all features, apps or services may be available with your plan, device operating system and software version. Please contact your wireless service provider for more information.

NOTE: Devices and software are constantly evolving – the screen images and icons you see here are for reference only.

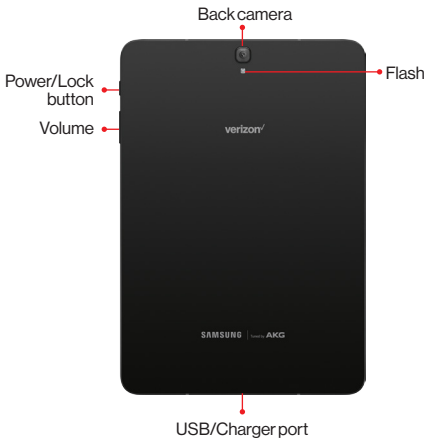

Using your tablet

Turning your tablet on/off

To turn your tablet on, press and hold the **Power/Lock** button.

Press the **Power/Lock** button again to turn it off.

Locking/unlocking the screen

To turn on your screen, press the **Power/Lock** button.

Then swipe up on the screen to unlock it.

To turn off your screen and prevent accidental key presses, press the **Power/Lock** button.

Activating your tablet

Activate your tablet to use the internet on Verizon's 4G LTE network.

1. Make sure your SIM card is inserted, and then turn on your tablet.
2. Follow the onscreen instructions in the Setup Wizard.

NOTE: Subject to specific terms of use. For coverage details, visit verizonwireless.com/CoverageLocator.

Using your S Pen

The S Pen™ lets you write and draw directly into emails or the calendar, as well as Word, Excel, PowerPoint, and PDF documents. Capture your ideas in Samsung Notes and even write a note on the back of a picture.

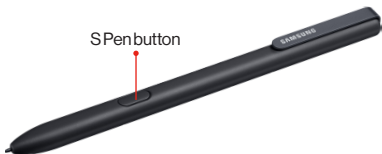

Press the **S Pen** button to launch Air command, for quick access to handy tools.



Create note: Create customized notes.



View all notes: View your customized notes.



Smart select: Outline and crop anything on the screen and freely edit or share with others.



Screen write: Capture a screen and write or draw on it.



Translate: Translate text.



Add shortcut: Add or remove a shortcut.

Attach the S Pen to your device

Use the internal magnet to attach the S Pen™ to the back of your tablet.

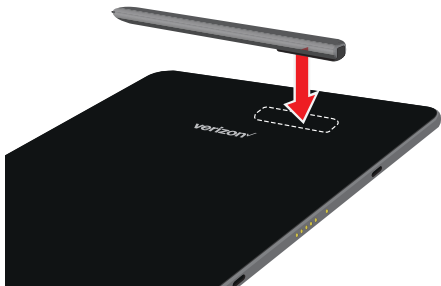

Learning more



Use the Help feature to access your device user manual and other information on how to use your phone.



Getting apps



Taking photos



Accessibility settings



To open the Help feature, tap **Apps** > **Settings** > **Help**.



Visit **[verizonwireless.com/Support](https://www.verizonwireless.com/Support)**.



Download a User Guide from **[verizonwireless.com/Support](https://www.verizonwireless.com/Support)** or call **888.987.HELP (4357)** to order a copy.

Managing your account



My Verizon Mobile app

Manage your account, track your usage, edit account information, pay your bill and more.



International travel

Visit [verizonwireless.com/International](https://www.verizonwireless.com/International) for features and rates when traveling outside the US.



Customer service

Call **800.922.0204**

Twitter **@VZWSupport**

Additional information

Your wireless device and third-party services

Verizon Wireless is the mobile carrier associated with this wireless device, but many services and features offered through this are provided by or in conjunction with third parties. Verizon Wireless is not responsible for your use of this device or any non-Verizon Wireless applications, services and products, including any personal information you choose to use, submit or share with others. Specific third-party terms and conditions, terms of use and privacy policies apply. Please review carefully all applicable terms, conditions and policies prior to using this wireless device and any associated application, product or service.

© 2017 Verizon Wireless. All Rights Reserved. Samsung and Galaxy Tab are both trademarks of Samsung Electronics Co., Ltd. Android, Google, Google Play, and other marks are trademarks of Google Inc. Other company and product names mentioned herein may be trademarks of their respective owners. Screen images simulated. Appearance of device may vary.

